

4680 Vinita Court  
Chino, CA 91710

# "FD2 SERIES" DEADBOLT with an "F SERIES" LEVER or KNOB in a STEEL DOOR IN SWING / OUT SWING "IMPACT"

**GENERAL NOTES**

1. This product has been evaluated and is in compliance with the 6th Edition (2017) Florida Building Code (FBC) structural requirements excluding the "High Velocity Hurricane Zone" (HVHZ).
2. Product anchors shall be as listed and spaced as shown on details. Anchor embedment to base material shall be beyond wall dressing or stucco. Anchors shown are for the door components only. Refer to the current Florida Statewide product approval for the anchoring of the door system to the substrate.
3. When used in areas requiring wind borne debris protection this product complies with FBC Sections 1609.1.2 & R301.2.1.2 and does not require an impact resistant covering. This product meets missile level "D" and includes Wind Zone 4 as defined in ASTM E 1996 and FBC Sections 1609.1.2.2 & R301.2.1.2.1.
4. This product has been tested in the door panels as specified in this approval. Substitution into a similar product may be approved for use by the local Authority Having Jurisdiction. In all cases, the steel door used must possess a comparable current Florida Statewide product approval w/ installation instructions. The door panel size and design pressure (DP) rating shall not exceed the sizes and DP ratings shown in this approval or the steel side hinged swing door approval being used.
5. Site conditions that deviate from the details of this drawing require further engineering analysis by a licensed engineer or registered architect.

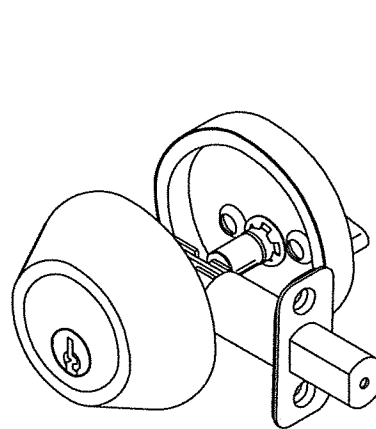

"FD2 Series" Deadbolt

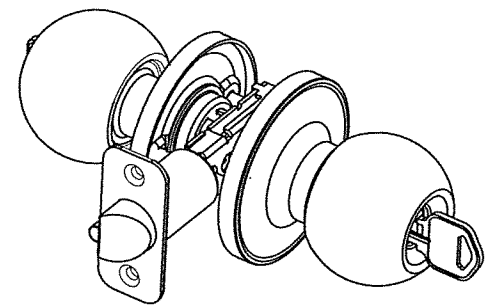

"F Series" Knob

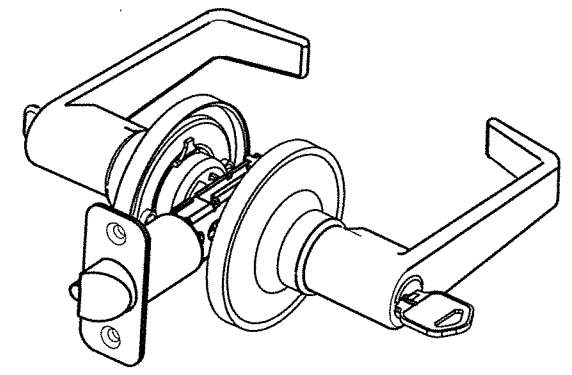

"F Series" Lever

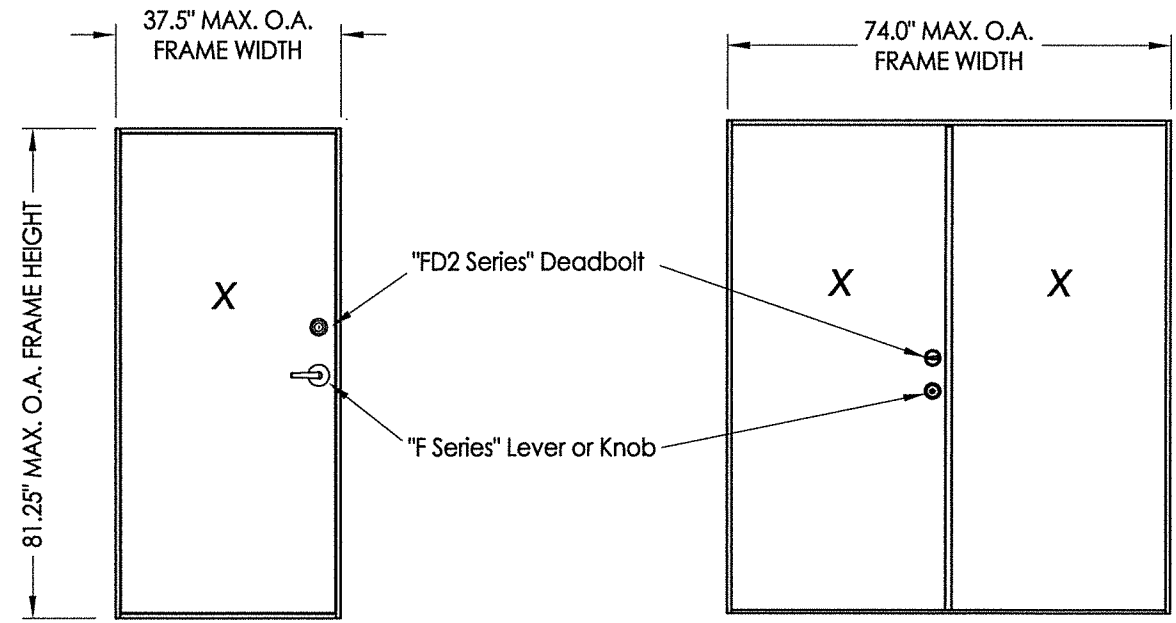

| CONFIGURATION                               | MAX FRAME DIMENSION | LOCK & DEADBOLT TYPE             | DESIGN PRESSURE (PSF) INSWING / OUTSWING |          |
|---|---------------------|----------------------------------|--|----------|
|   |                     |                                  | POSITIVE                                 | NEGATIVE |
| SINGLE (opaque)                             | 37.5" x 81.25"      | "FD2 Series" Deadbolt with a     | +65.0                                    | -70.0    |
| SINGLE (glazed)<br>DOUBLE (opaque / glazed) | 74.5" x 81.25"      | "F Series" Lever or Knob (PAMEX) | +45.0                                    | -50.0    |

| TABLE OF CONTENTS |   |
|-------------------|---|
| SHEET#            | DESCRIPTION   |
| 1                 | Typical elevation, design pressures & general notes |
| 2                 | "FD2 Series" deadbolt & installation details        |
| 3                 | "F Series" knob & lever details                     |
| 4                 | Steel door panel details                            |

Documents Prepared By: **LFS**  
 Lyndon F. Schmidt  
 P.E. No. 43409  
 Date: 10.3.17

**RW**  
 BUILDING CONSULTANTS, INC.  
 P.O. Box 230, Valrico, FL 33595  
 Phone No.: 813.659.9197  
 FBPE C.A. No. 9813

|   |          |
|---|----------|
| PRODUCT: PAMEX LOCK AND DEADBOLT                                      |          |
| PART OR ASSEMBLY: TYPICAL ELEVATION, DESIGN PRESSURES & GENERAL NOTES |          |
| NO.   | DATE     |
| 3   | 10/03/17 |
| 2   | 3/27/15  |
| 1   | 4/24/12  |
| REVISIONS   |          |
| DATE: 8/01/11   |          |
| SCALE: N.T.S.   |          |
| DWG. BY: JK   |          |
| CHK. BY: LFS  |          |
| DRAWING NO.: FL-14722.4   |          |
| SHEET 1 OF 4  |          |

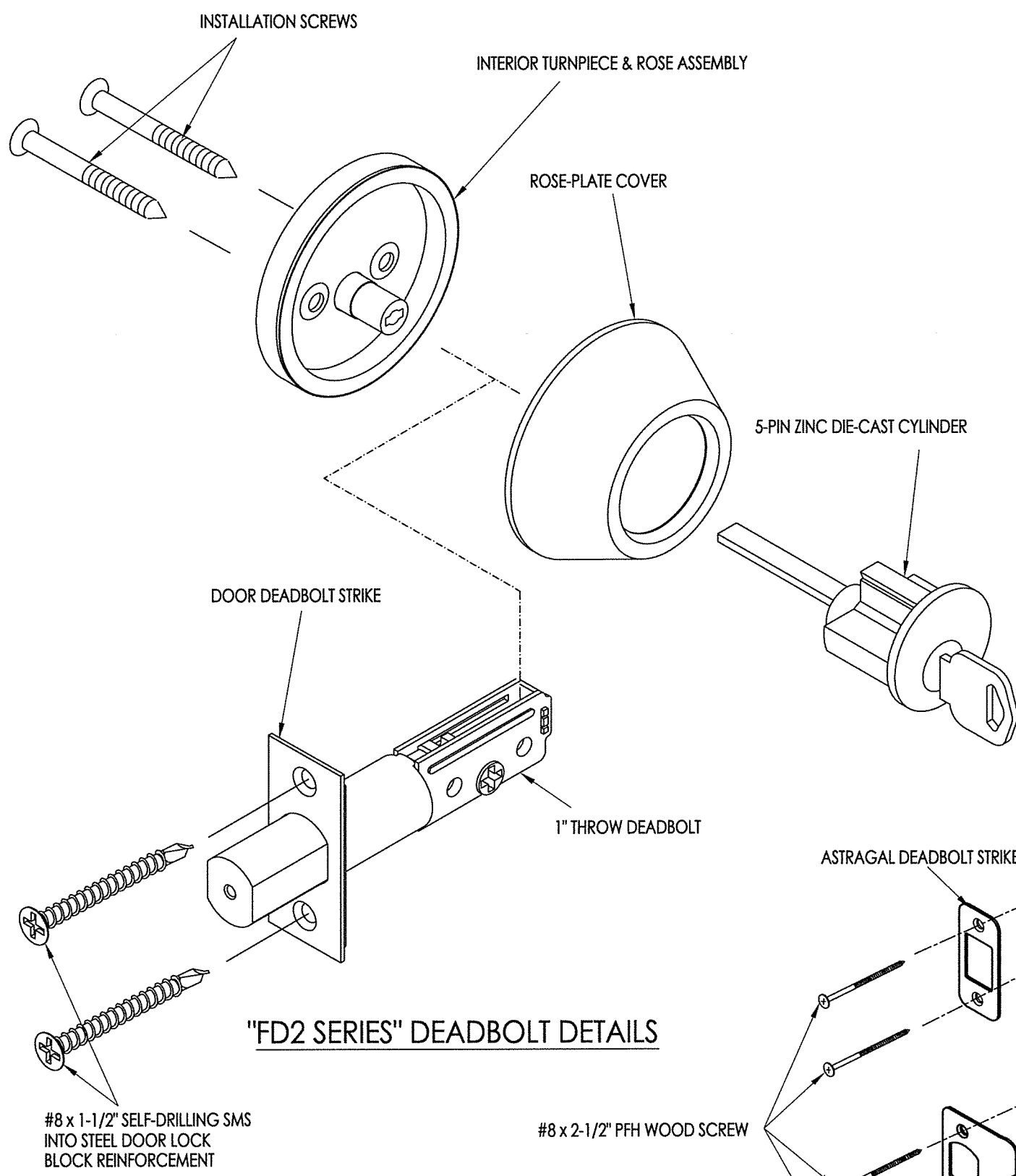

**"FD2 SERIES" DEADBOLT DETAILS**

- NOTES :**
1. Wood screw installation requires 1.5" min. embedment into wood substrate ( $G \geq 0.55$ ).
  2. Wood screw installation requires 2" min. embedment into wood substrate ( $G \geq 0.55$ ).
  3. Concrete screw installation requires 1.25" min. embedment into concrete (conforming to ACI 301, 3000 psi min.) or hollow block (conforming to ASTM C-90) and maintaining a min. 3" edge distance and 1-1/2" min. center-to-center spacing of anchors.

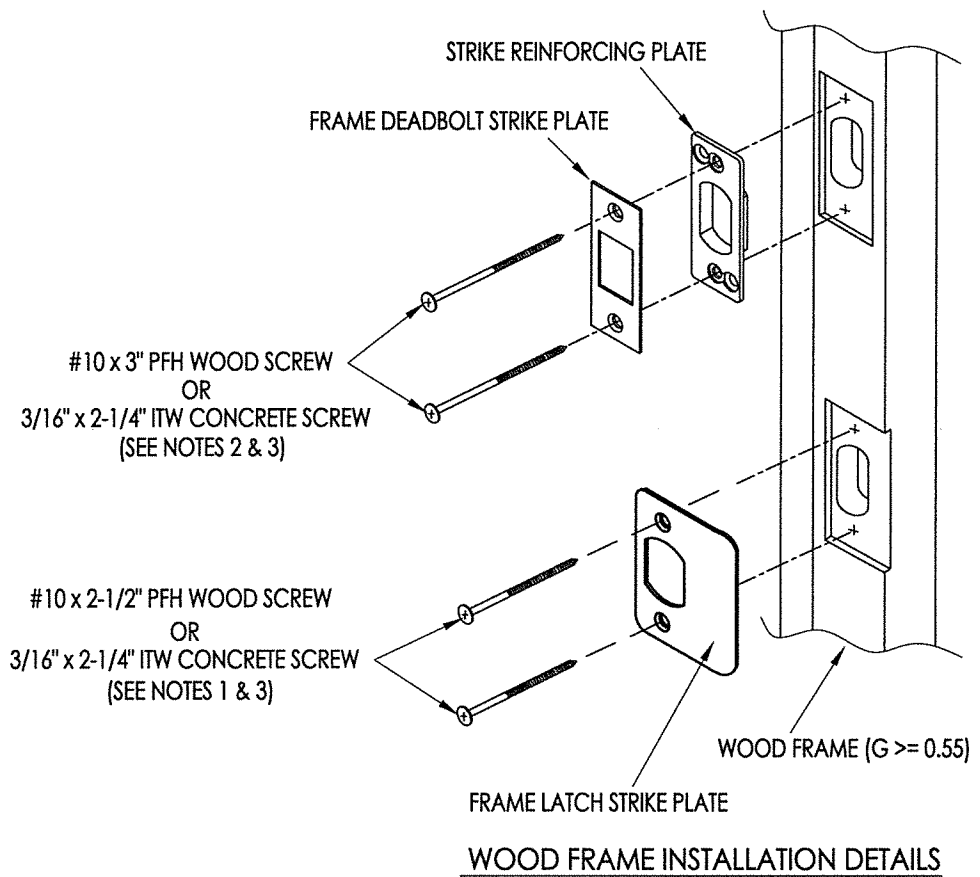

**WOOD FRAME INSTALLATION DETAILS**

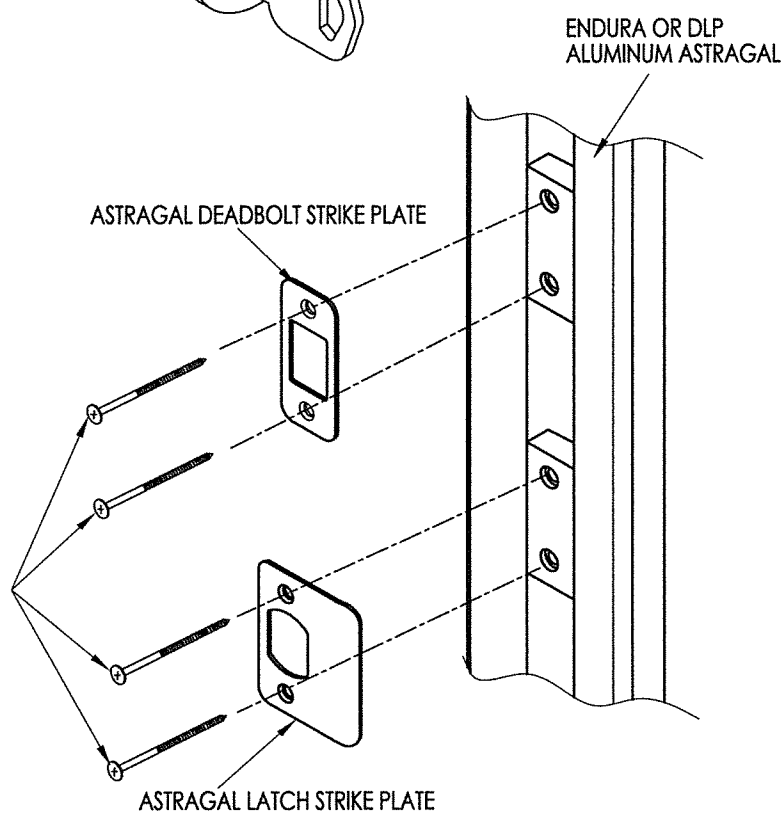

**DOUBLE DOOR INSTALLATION DETAILS**

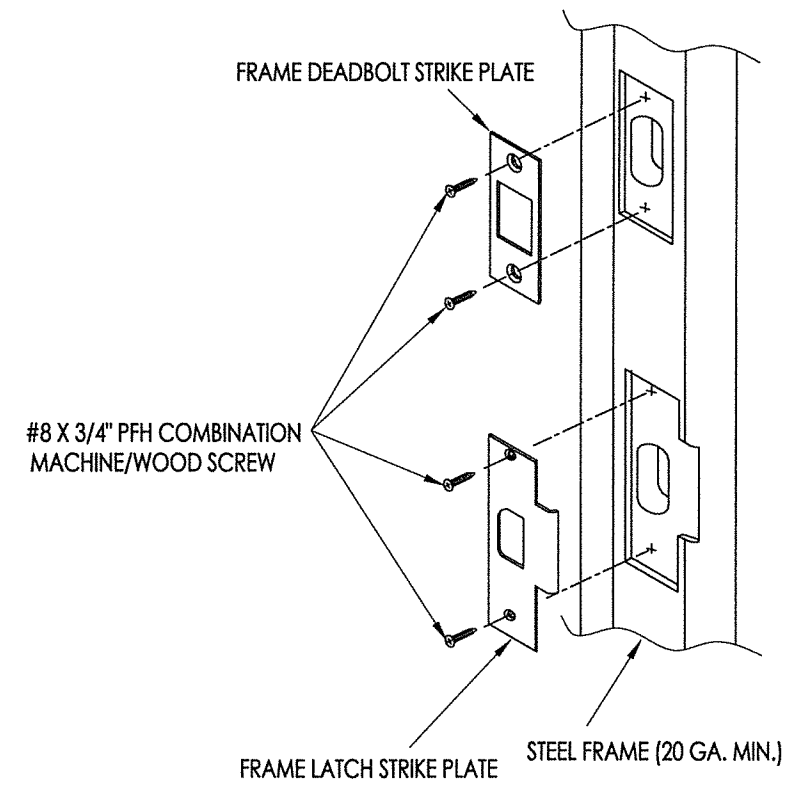

**STEEL FRAME INSTALLATION DETAILS**

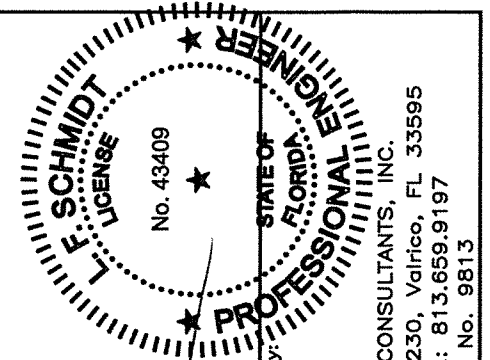

Documents Prepared By:  
 Lyndon F. Schmidt  
 P.E. No. 43409

*RW* BUILDING CONSULTANTS, INC.  
 P.O. Box 230, Valrico, FL 33595  
 Phone No.: 813.659.9197  
 FBPE C.A. No. 9813

|                   |  |
|-------------------|--|
| PRODUCT:          | PAMEX LOCK AND DEADBOLT                      |
| PART OR ASSEMBLY: | "FD2 SERIES" DEADBOLT & INSTALLATION DETAILS |

| NO. | DATE     | REVISIONS                        |
|-----|----------|----------------------------------|
| 3   | 10/03/17 | UPDATE TO 6TH ED. (2017) FBC LFS |
| 2   | 3/18/15  | UPDATE TO 5TH ED. (2014) FBC JK  |
| 1   | 4/24/12  | UPDATE TO 2010 FBC JK            |
|     |          | BY                               |

|              |            |
|--------------|------------|
| DATE:        | 8/01/11    |
| SCALE:       | N.T.S.     |
| DWG. BY:     | JK         |
| CHK. BY:     | LFS        |
| DRAWING NO.: | FL-14722.4 |
| SHEET        | 2 OF 4     |

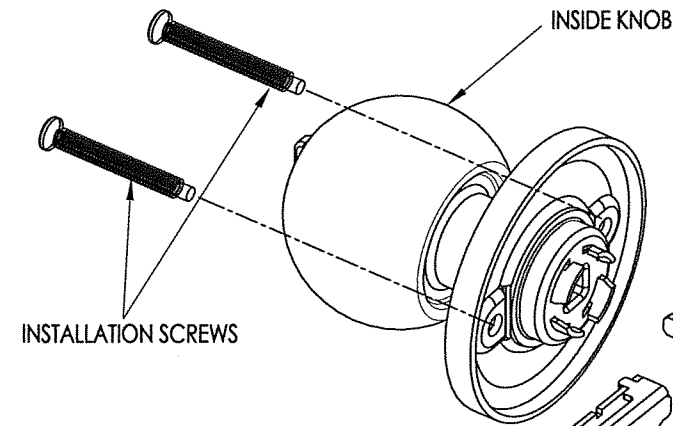

INSTALLATION SCREWS

INSIDE KNOB

FACEPLATE

5-PIN OR 6-PIN BRASS CYLINDER

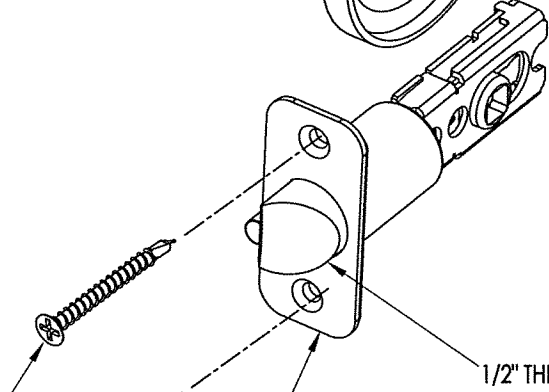

1/2" THROW ADJUSTABLE LATCH

DOOR LATCH STRIKE

#8 x 1-1/2" SELF-DRILLING SMS INTO STEEL DOOR LOCK BLOCK REINFORCEMENT

**"F SERIES" KNOB DETAILS**

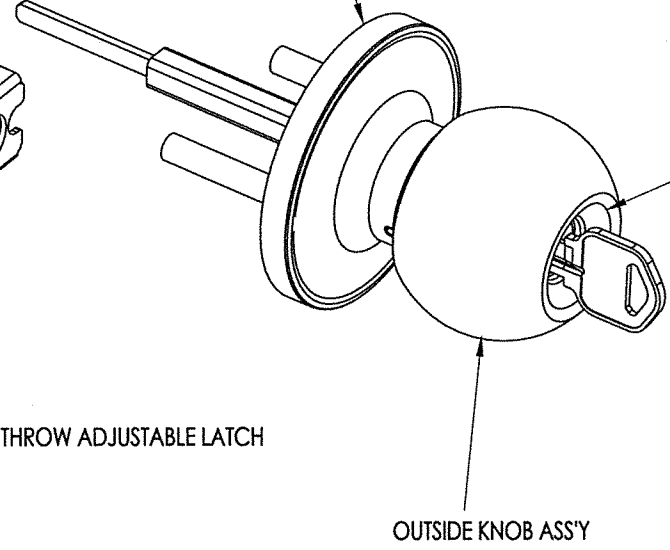

OUTSIDE KNOB ASS'Y

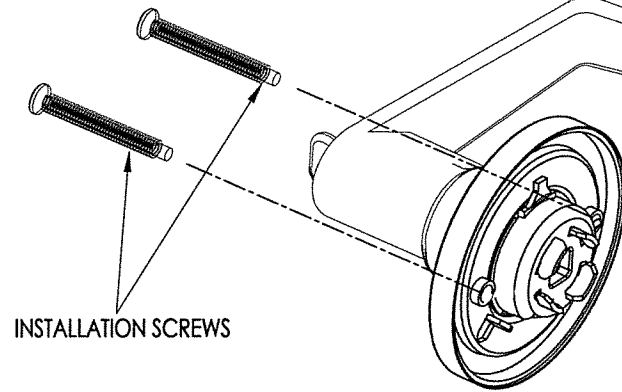

INSTALLATION SCREWS

INSIDE LEVER

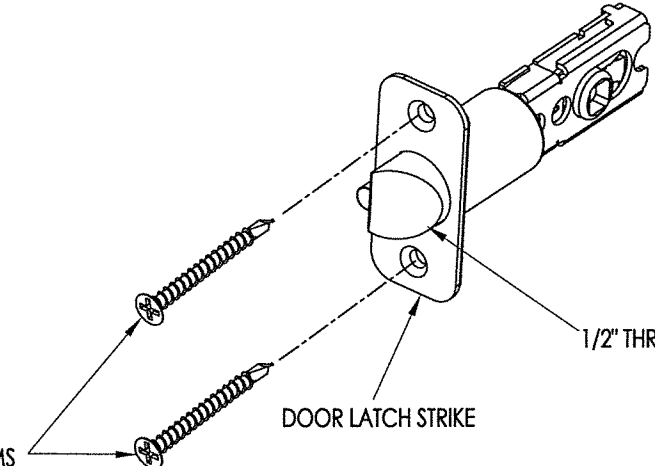

1/2" THROW ADJUSTABLE LATCH

DOOR LATCH STRIKE

#8 x 1-1/2" SELF-DRILLING SMS INTO STEEL DOOR LOCK BLOCK REINFORCEMENT

**"F SERIES" LEVER DETAILS**

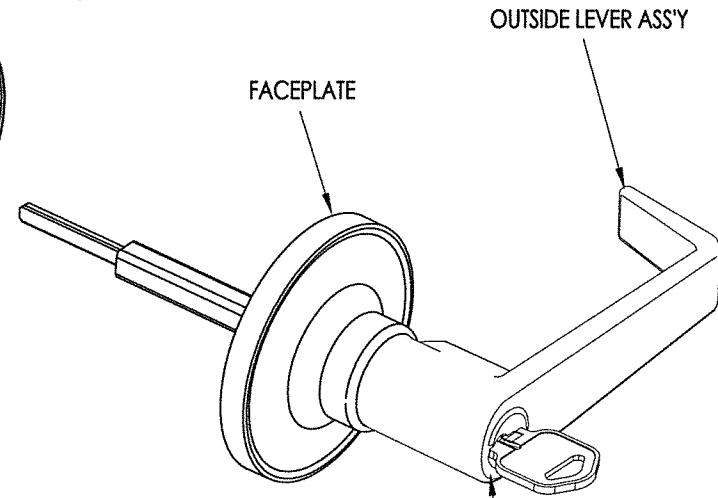

FACEPLATE

OUTSIDE LEVER ASS'Y

5-PIN OR 6-PIN BRASS CYLINDER

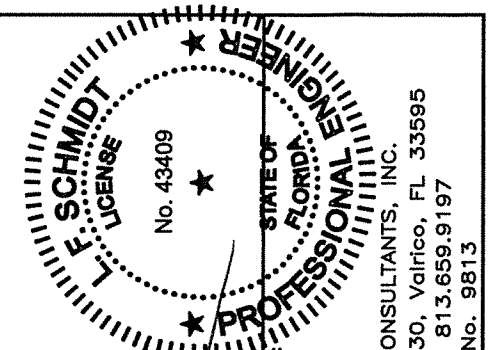

Documents Prepared By:  
Lyndon F. Schmidt  
P.E. No. 43409

**RW** BUILDING CONSULTANTS, INC.  
P.O. Box 230, Valrico, FL 33595  
Phone No.: 813.659.9197  
FBPE C.A. No. 9813

|                   |                                    |
|-------------------|------------------------------------|
| PRODUCT:          | PAMEX<br>LOCK AND DEADBOLT         |
| PART OR ASSEMBLY: | "F SERIES"<br>KNOB & LEVER DETAILS |

| NO. | DATE     | BY  | REVISIONS                    |
|-----|----------|-----|------------------------------|
| 3   | 10/03/17 | LFS | UPDATE TO 6TH ED. (2017) FBC |
| 2   | 3/18/15  | JK  | UPDATE TO 5TH ED. (2014) FBC |
| 1   | 4/24/12  | JK  | UPDATE TO 2010 FBC           |

|              |            |
|--------------|------------|
| DATE:        | 8/01/11    |
| SCALE:       | N.T.S.     |
| DWG. BY:     | JK         |
| CHK. BY:     | LFS        |
| DRAWING NO.: | FL-14722.4 |
| SHEET        | 3 of 4     |

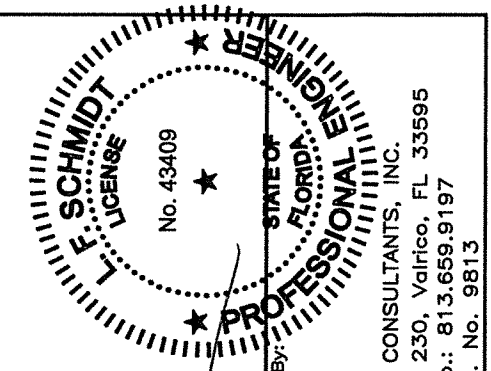
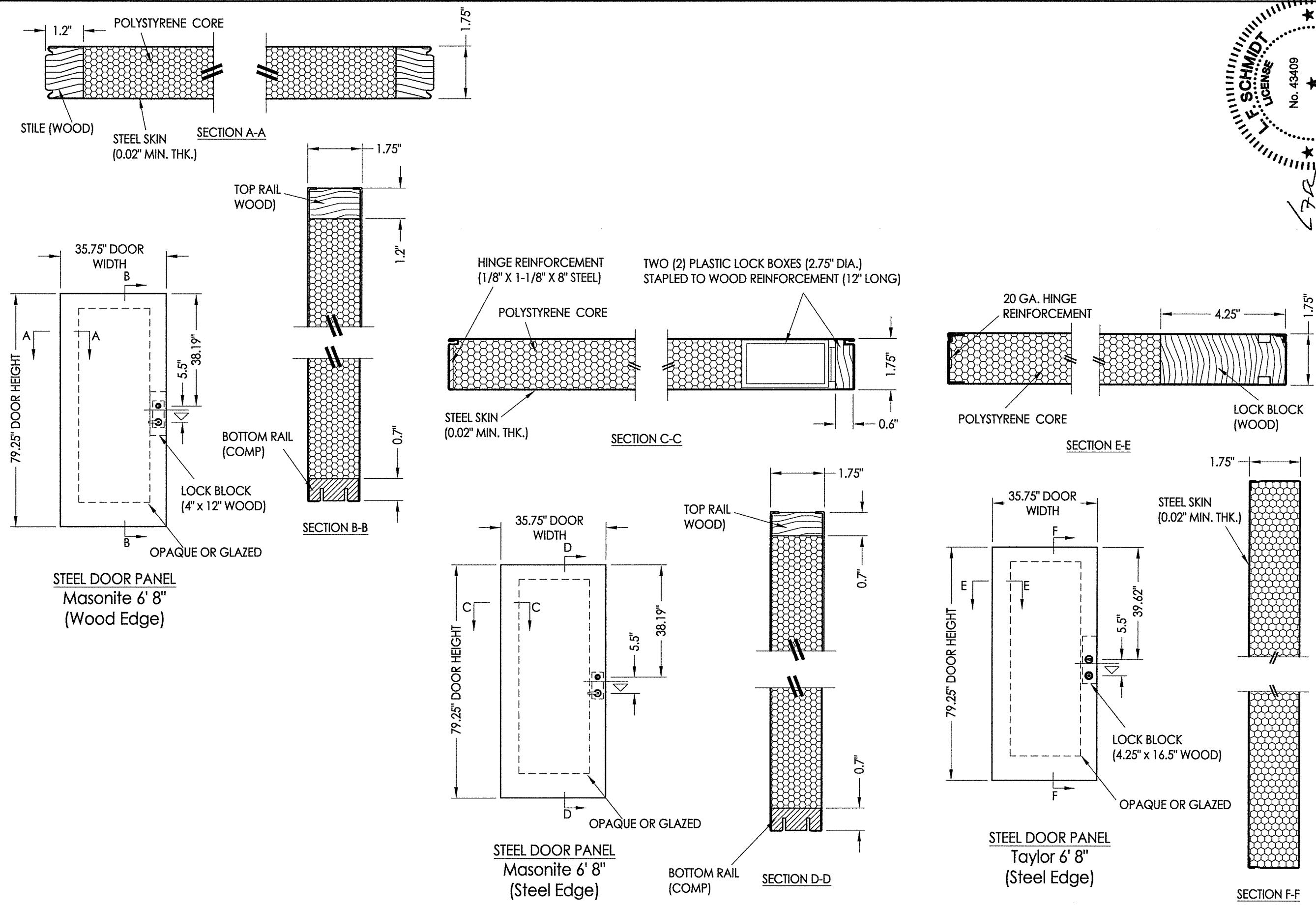

Documents Prepared By:  
 Lyndon F. Schmidt  
 P.E. No. 43409

**R.W.** BUILDING CONSULTANTS, INC.  
 P.O. Box 230, Valrico, FL 33595  
 Phone No.: 813.659.9197  
 FBPE C.A. No. 9813

|                   |                          |
|-------------------|--------------------------|
| PRODUCT:          | PAMEX LOCK AND DEADBOLT  |
| PART OR ASSEMBLY: | STEEL DOOR PANEL DETAILS |

| NO. | DATE     | BY  | REVISIONS                    |
|-----|----------|-----|------------------------------|
| 3   | 10/03/17 | LFS | UPDATE TO 6TH ED. (2017) FBC |
| 2   | 3/27/15  | JK  | UPDATE TO 5TH ED. (2014) FBC |
| 1   | 4/24/12  | JK  | UPDATE TO 2010 FBC           |

|              |            |
|--------------|------------|
| DATE:        | 8/01/11    |
| SCALE:       | N.T.S.     |
| DWG. BY:     | JK         |
| CHK. BY:     | LFS        |
| DRAWING NO.: | FL-14722.4 |
| SHEET        | 4 OF 4     |